

This installation should be done at an installed ramp in the car.
It is possible at ramps in stock but you need to unfold the ramp.

Needed tools:
Allen key 6 mm + 3 mm

Warning: Always check the position of the T nuts after fitting. They must be at an straight angle with the slot in the Alu profile

Needed parts
Leg kit AR 200 073

Unfold the ramp.

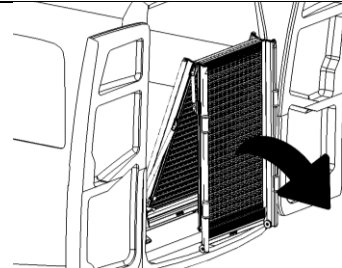

Remove the centre gas spring including the ball joint from the bracket on platform 1 by unscrewing the M8 nut holding the ball joint in place.

Remove the mounting bracket and leave the T Nuts in the slot from the side profile.

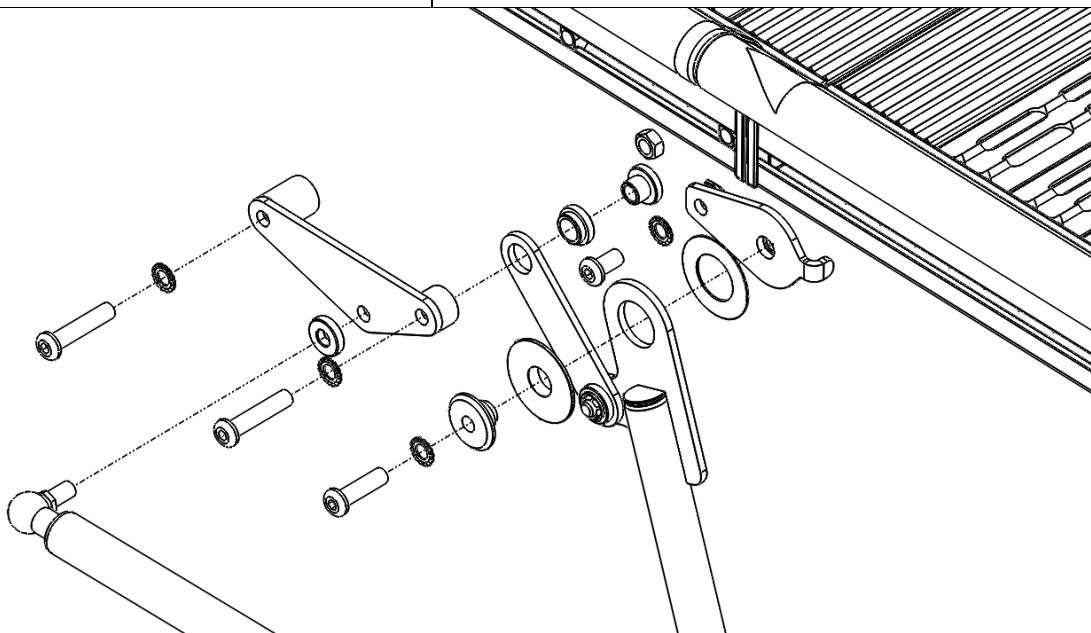
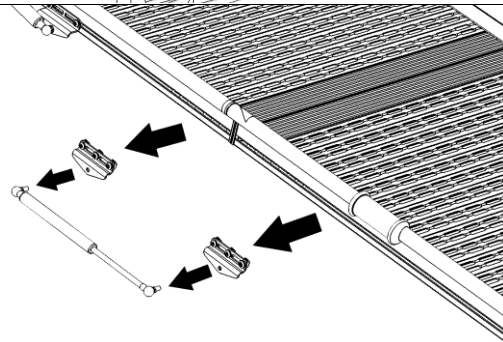

- mount the bracket of the leg using the T nuts of the previous bracket following beside picture.

- Make sure it is mounted as far to the plastic end cap as possible.

- Tighten the bolts M8 (30 Nm)

- check the position of the T nuts

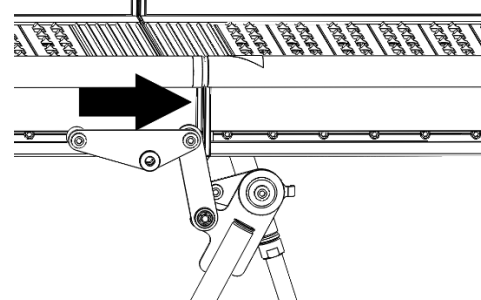

- Mount the leg hinge part at the second platform, as far to the plastic end cap as possible.
- Make sure the lip falls in slot.
- Tighten the bolts M8. (30 Nm)
- check the position of the T nuts

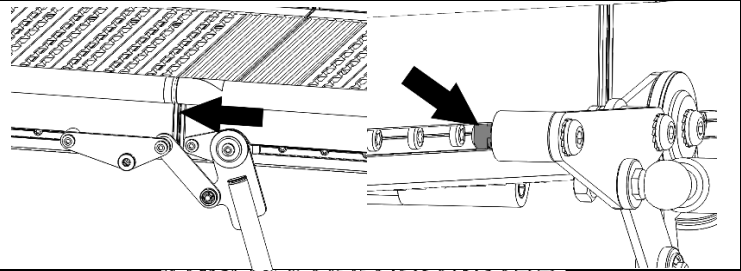

Flip over the gas spring mounting bracket, so the ball is facing up instead of down.
Do not tighten the bolts entirely so the bracket can still slide in the slot.

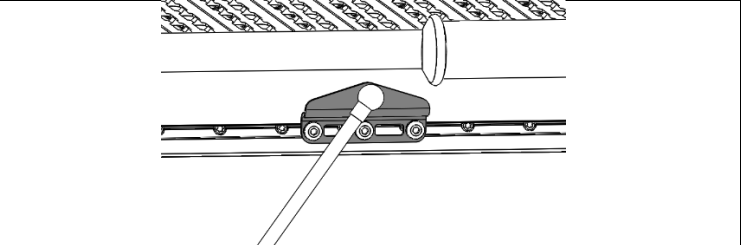

Mount the gas spring to the bracket of the leg and move the other bracket to the furthest extend and tighten the bolts

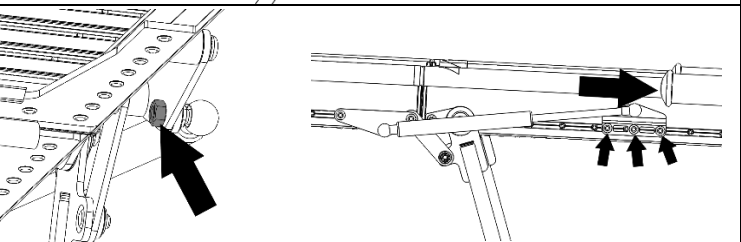

Mounting the right leg

Mount the turning point of the push rod at platform 1 as far to the plastic end cap as possible.

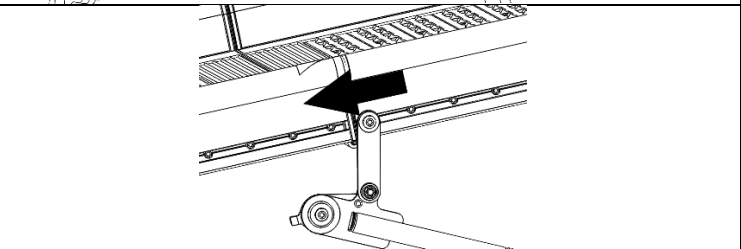

Mount the turning point of the leg as close to the plastic end cap as possible, make sure the lip falls in the slot before tightening the M8 bolts
- check the position of the T nuts

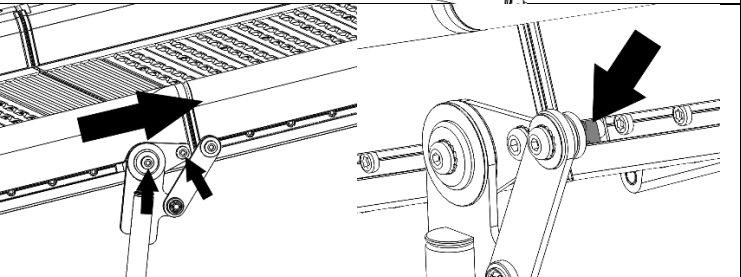

Place the holding blocks for the legs in such a way they hug the legs when the ramp is closed.

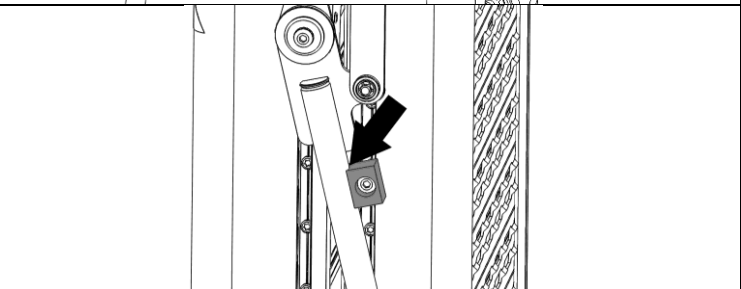

Adjust the length of the leg on both sides by turning in or out the leg feet.
At a flat ground, with the ramp unfolded from the vehicle, the legs should be approx. **1 cm free** from the floor.
Fix the legs with the set screw.

And you are ready

